

SOLID BEARING RODLESS BAND CYLINDER MXP-S

The MXP-S rodless pneumatic band cylinder is designed for applications requiring moderate load carrying and guidance. The MXP-S band cylinder utilizes two field replaceable solid bearings that optimize stress distribution for optimal performance.

STAINLESS STEEL BANDS WITH NON-WEAR BAND RETENTION

- Durable, flexible, corrosion & fatigue resistant stainless steel of the dust & sealing bands are magnetically retained and are not subject to wear and stretch like materials used by competitors
- Wipers, dust & sealing band all prevent contaminants from entering the cylinder interior, protecting components for increased life

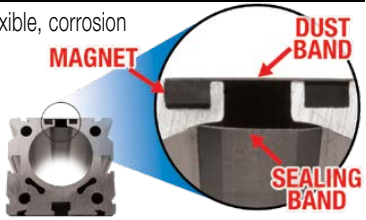

ADJUSTABLE CUSHIONS

- Adjustable cushions with retained stainless steel needle screw for increased safety
- Easy screw adjustment for smooth deceleration protecting actuator from high stress at end-of-stroke

TRAPEZOIDAL BEARINGS

- Trapezoidal design maximizes bearing surface area for less pressure on bearing surfaces; resulting in less wear
- Bearings are tensioned indirectly, providing bind free adjustment
- Field replaceable for extended service life

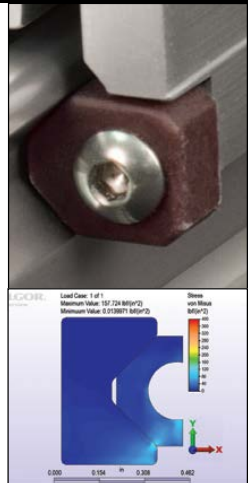

ISOLATED PISTON

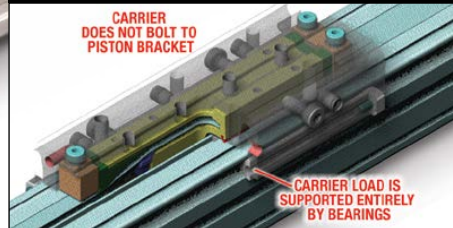

- Unique design isolates the piston from the applied load, extending the service life of the piston seals



Applications:

- Animatronic robots
- Automotive
- Bag positioning
- Carton filling
- Clamping
- Conveying
- Conveyor door control
- Diverting
- Material Handling
- Packaging
- Palletizing
- Pick & place
- Pull-off system
- Test stands
- Transfer station
- Theater animations
- Wire winding
- and many more

Standard Features:

Mounting
Direct mount via head bolts; US Standard or Metric

Carrier
Large flexible mounting pattern

Sensors
Internal magnet

Porting
4 ported heads; NPT, Metric Parallel (ISO-G/BSP) & Metric Taper (Rc/BST) available on both metric and US standard mount actuators

Available Options:

Mounting
Tube clamps; Foot mounts

Carrier
Auxiliary carrier; Floating mount

Sensors
Reed, Solid State PNP or NPN, all available normally open or normally closed

Porting
Single end porting

Shock Absorbers
Fixed or adjustable position shocks

SOLID BEARING RODLESS BAND CYLINDER

MXP-S

BORE	BENDING MOMENTS			LOAD	THRUST	
	Mx	My	Mz	Fz	(at 100 PSI)	
in	(in-lbs)			lbf	lbf	
16	0.63	22	19	25	35	30.7
25	1.00	60	110	34	70	78.5
32	1.25	100	350	140	150	123
40	1.50	275	600	220	225	177
50	2.00	315	1,155	341	315	314
63	2.50	585	2,340	520	520	491

BORE	BENDING MOMENTS			LOAD	THRUST	
	Mx	My	Mz	Fz	(at 6.9 bar)	
mm	(N-m)			N	N	
16	16	2.5	2.1	2.8	156	136
25	25	6.8	12.4	3.8	311	349
32	32	11.3	39.5	15.8	667	546
40	38	31.1	67.8	24.9	1,001	786
50	50	35.6	131	38.5	1,401	1,397
63	64	66.1	264	58.8	2,313	2,184

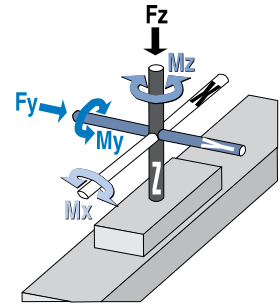

Dimensions

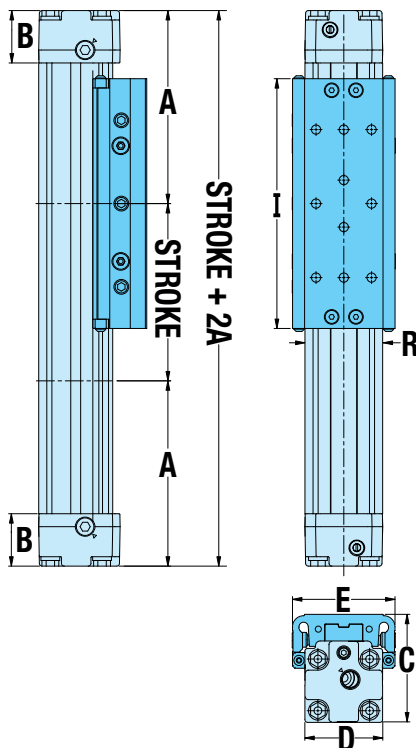

	16	25	32	40	50	63
A	3.13	3.94	4.90	5.82	6.29	8.45
B	0.55	1.11	1.50	1.50	1.97	1.97
C	1.80	2.30	3.06	3.51	4.44	5.48
D	1.17	1.65	2.18	2.52	3.10	3.94
E	1.58	2.18	2.86	3.47	4.01	5.59
I	4.12	5.31	6.02	7.87	7.91	12.11
R	1.18	1.65	2.18	2.52	3.10	3.94

Dimensions in inches

	16	25	32	40	50	63
A	79.6	100.2	124.5	147.7	159.8	214.5
B	14.0	28.3	38.1	38.0	50.0	50.0
C	45.8	58.4	77.8	89.2	112.8	139.1
D	29.8	42.0	55.4	64.0	78.7	100.0
E	40.1	55.4	72.6	88.2	104.1	142.0
I	104.6	135.0	153.0	200.0	200.8	307.5
R	30.0	42.0	55.4	64.0	78.7	100.0

Dimensions in millimeters

BC2 Replacement

The MXP-S and the BC2 carriers have the same carrier height and bolt hole pattern (+ additional). If you are replacing the BC2 consider the 21st century design of the MXP-S with its high preforming bearing system and non-wear band system.

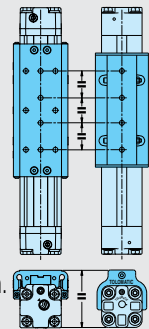

Tolomatic™

EXCELLENCE IN MOTION

COMPANY WITH
QUALITY SYSTEM
CERTIFIED BY DNV GL
= ISO 9001 =
Certified site: Hamel, MN

USA

Tolomatic Inc.
3800 County Road 116
Hamel, MN 55340, USA
Phone: (763) 478-8000
Fax: (763) 478-8080
Toll-Free: **1-800-328-2174**
sales@tolomatic.com
www.tolomatic.com

CHINA

Tolomatic Automation Products (Suzhou) Co. Ltd.
(ServoWeld® inquiries only)
No. 60 Chuangye Street, Building 2
Huqiu District, SND Suzhou
Jiangsu 215011 - P.R. China
Phone: +86 (512) 6750-8506
Fax: +86 (512) 6750-8507
ServoWeldChina@tolomatic.com

EUROPE

Tolomatic Europe GmbH
Elisabethenstr. 20
65428 Rüsselsheim
Germany
Phone: +49 6142 17604-0
help@tolomatic.eu

All brand and product names are trademarks or registered trademarks of their respective owners. Information in this document is believed accurate at time of printing. However, Tolomatic assumes no responsibility for its use or for any errors

that may appear in this document. Tolomatic reserves the right to change the design or operation of the equipment described herein and any associated motion products without notice. Information in this document is subject to change without notice.

Visit www.tolomatic.com for the most up-to-date technical information