

1209C Disc/Cone Clutch

Models: 1209-0016
1209-0018
1209-0020
1209-0022

(02/01/2026)
DISCONTINUED
PRODUCT STYLE OR
SIZE. PARTS SHEET
IS FOR REPAIR
INSTRUCTIONS ONLY.

Parts listing is for
reference only. All
parts listed are
limited to stock
on hand. Contact
Tolomatic regarding
availability.

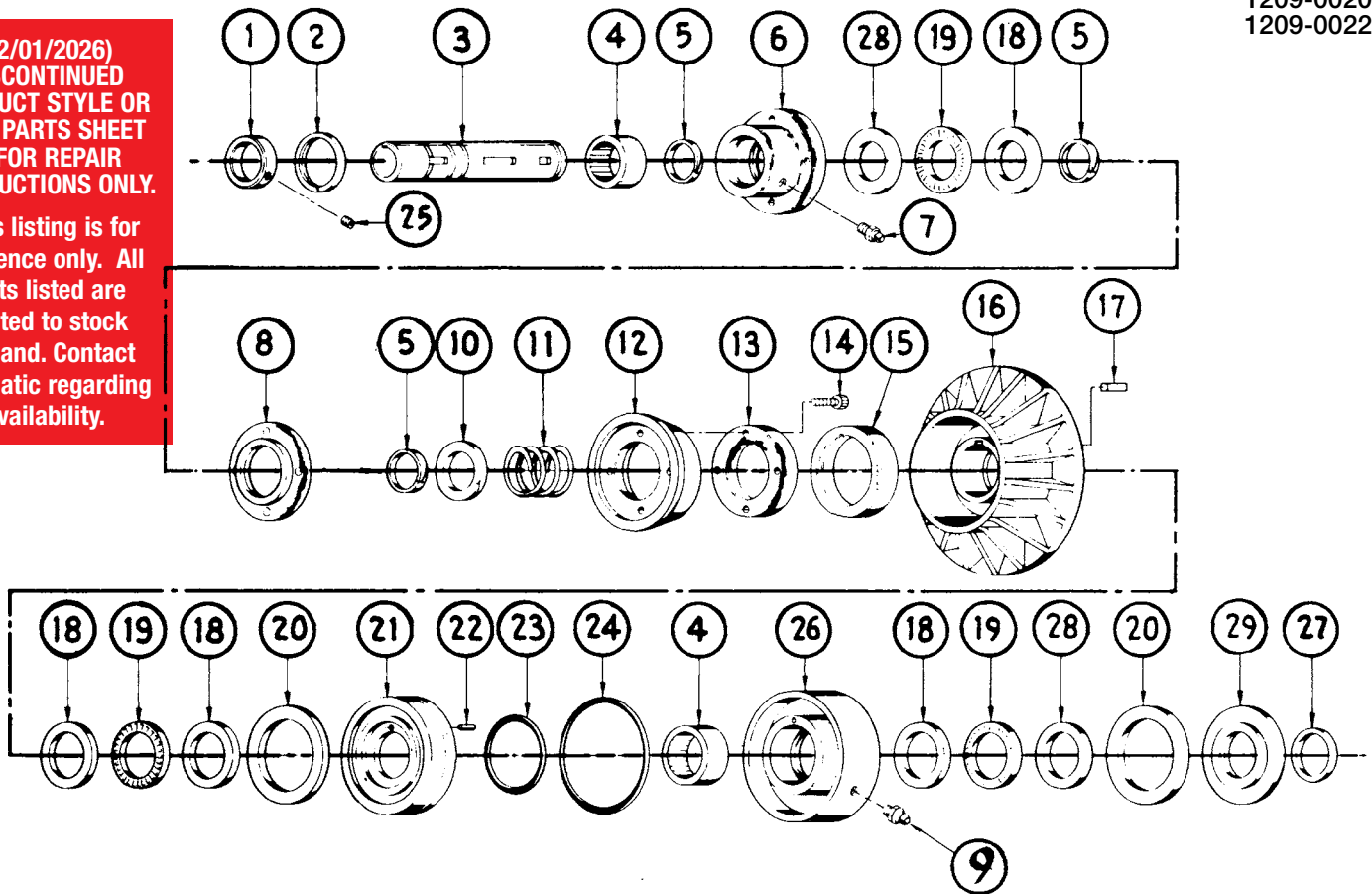

Parts Listing

| ITEM | PART NO. | DESCRIPTION | Quantity | | | |
|------|-----------|---------------------|-----------|-----------|-----------|-----------|
| | | | 1209-0016 | 1209-0018 | 1209-0020 | 1209-0022 |
| 1 | 1209-1013 | Collar | | | | 1 |
| 2 | 1209-1016 | Retaining Ring | 1 | 1 | 1 | 1 |
| 3 | 1209-1024 | Shaft, 1" Bore | 1 | | | |
| | 1209-1022 | Shaft, 1-1/8" Bore | | 1 | | |
| | 1209-1020 | Shaft, 1-1/4" Bore | | | 1 | |
| | 1209-1000 | Shaft, 1-3/8" Bore | | | | 1 |
| 4 | 1309-1017 | Needle Bearing | 1 | 1 | 1 | 1 |
| 5 | 1309-1011 | Retaining Ring | 2 | 2 | 2 | 2 |
| 6 | 1209-1018 | Adapter | 1 | 1 | 1 | 1 |
| 7 | 0100-1601 | Zerk Grease Fitting | 1 | 1 | 1 | 1 |
| 8 | 1209-1002 | Cone, Adapter | 1 | 1 | 1 | 1 |
| 9 | 1208-1034 | Zerk Grease Fitting | 1 | 1 | 1 | 1 |
| 10 | 1209-1008 | Washer | 1 | 1 | 1 | 1 |
| 11 | 1209-1009 | Compression Spring | 1 | 1 | 1 | 1 |
| 12 | 1209-1003 | Clutch Cone | 1 | 1 | 1 | 1 |
| 13 | 1309-2007 | Clutch Ring Adapter | 1 | 1 | 1 | 1 |
| 14 | 1209-1019 | Soc. Hd. Cap Screw | 4 | 4 | 4 | 4 |
| 15 | 1309-2003 | Felt Retaining Seal | 1 | 1 | 1 | 1 |

| ITEM | PART NO. | DESCRIPTION | Quantity | | | |
|------|-----------|--------------------|-----------|-----------|-----------|-----------|
| | | | 1209-0016 | 1209-0018 | 1209-0020 | 1209-0022 |
| 16 | 1209-1004 | Cup | 1 | 1 | 1 | 1 |
| 17 | 1309-1010 | Key | 1 | 1 | 1 | 1 |
| 18 | 1309-1020 | Thrust Race Washer | 4 | 4 | 4 | 4 |
| 19 | 1309-1018 | Thrust Bearing | 3 | 3 | 3 | 3 |
| 20 | 1209-1010 | Felt Seal | 2 | 2 | 2 | 2 |
| 21 | 1209-1005 | Piston | 1 | 1 | 1 | 1 |
| 22 | 1209-1017 | Spring Pin | 1 | 1 | 1 | 1 |
| 23 | 1209-1015 | O-Ring | 1 | 1 | 1 | 1 |
| 24 | 1029-1033 | O-Ring | 1 | 1 | 1 | 1 |
| 25 | 1303-1174 | Set Screw | 2 | 2 | 2 | |
| | 1308-1013 | Set Screw | | | | 2 |
| 26 | 1209-1006 | Clutch Cylinder | 1 | 1 | 1 | 1 |
| 27 | 1209-1060 | Retaining Ring | 1 | 1 | 1 | 1 |
| 28 | 1309-2019 | Thrust Race Washer | 2 | 2 | 2 | 2 |
| 30 | 1209-1007 | Felt Seal Washer | 1 | 1 | 1 | 1 |

Installation

1. Slip the clutch over the shaft to the desired position, align with keyway and insert key (#17). After final alignment with mating sprocket or sheave, tighten set screws (#25) to lock clutch in place.
2. Connect air or hydraulic source not exceeding 100 psi (7 bars) pressure to cylinder port. Make sure no side or end thrust is transmitted to clutch. Flexible hose (not plastic tubing) may be used. A restraining member may be necessary to prevent cylinder rotation.

**(02/01/2026) DISCONTINUED PRODUCT
STYLE OR SIZE. PARTS SHEET IS FOR
REPAIR INSTRUCTIONS ONLY.**

**Parts listing is for reference only. All
parts listed are limited to stock on hand.
Contact Tolomatic regarding availability.**

Maintenance

- Lubrication will be required after every four (4) weeks of operation. Use a lubricant such as Mobilith® SHC 460 or equivalent. Two zerk fittings are provided for this purpose.
- After long periods of operation, it may be necessary to disassemble the clutch for cleaning and inspection.

**⚠ CAUTION! CLUTCHES ARE UNDER SPRING TENSION.
USE CARE WHEN DIS-ASSEMBLING.**

To Disassemble:

1. Remove the retaining ring (#27) from the cylinder end of the clutch shaft and slide all parts off this end.
2. Assemble all parts onto the shaft from the opposite end. This procedure is necessary to keep from damaging the edges of the bearing seal lips. See exploded view on the other side for proper sequence of assembly.
3. Wipe off all of the old lubricant before applying fresh grease. Use Mobilith® SHC 460 or equivalent. If it is necessary to remove the piston from the cylinder, re-lubricate the O-rings with a mineral-based O-ring grease. Also remove any grease that may have contacted the cone and clean out any foreign material in the cup. Be careful not to re-contaminate any internal parts.

Mobilith® SHC 460 is a registered trademark of Exxon Mobil Corporation, www.mobil.com

TolomaticTM
EXCELLENCE IN MOTION

3800 County Road 116, Hamel, MN 55340 USA
<http://www.Tolomatic.com> • Email: Help@Tolomatic.com
Phone: (763) 478-8000 • Toll Free: 1-800-328-2174

COMPANY WITH
QUALITY SYSTEM
CERTIFIED BY DNV
= ISO 9001 =

All brand and product names are trademarks or registered trademarks of their respective owners. Information in this document is believed accurate at time of printing. However, Tolomatic assumes no responsibility for its use or for any errors that may appear in this document. Tolomatic reserves the right to change the design or operation of the equipment described herein and any associated motion products without notice. Information in this document is subject to change without notice.

Visit www.tolomatic.com for the most up-to-date technical information